

Forme · Formes · Shapes · Formen · Formas

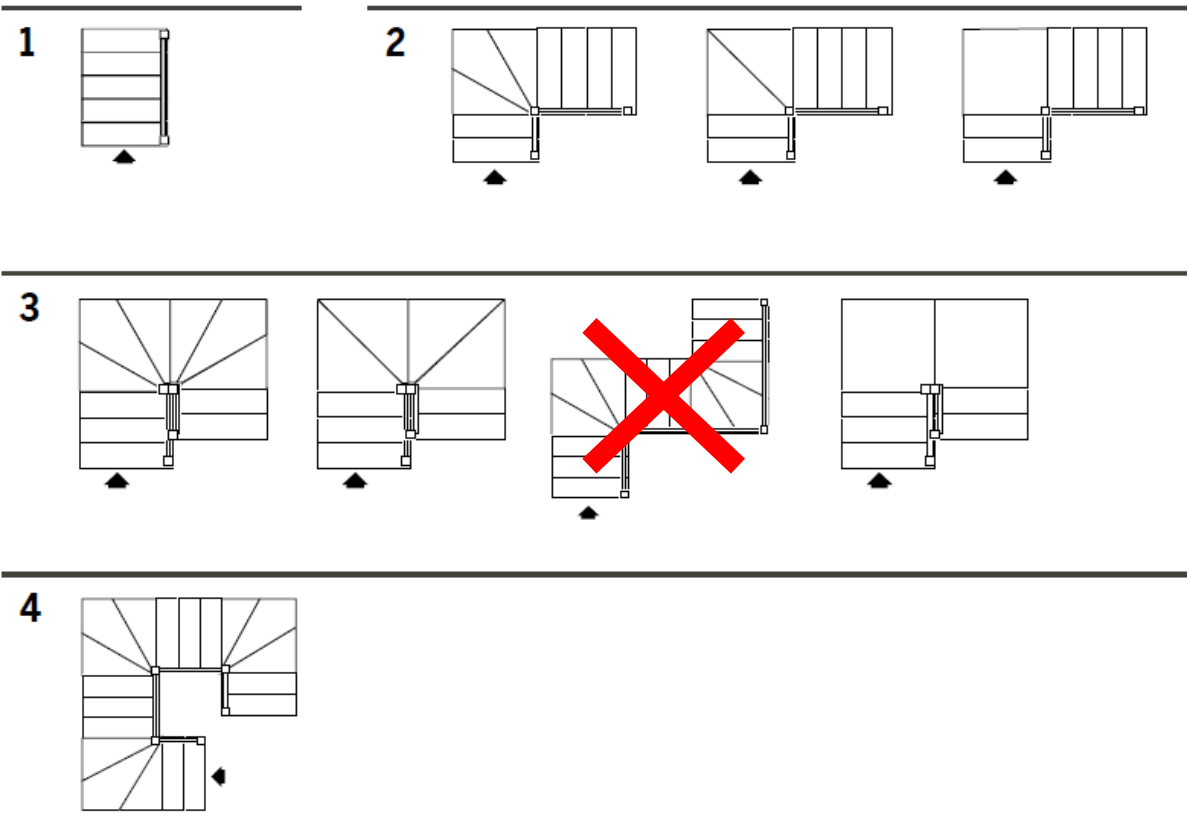

	G10	G11	G12	G13	G14	G15	G16	G17
	h	h	h	h	h	h	h	h
	1870 2310	2040 2520	2210 2730	2380 2940	2550 3150	2720 3360	2890 3570	3060 3780



Forma 1

Shape 1
Forme1
Form 1

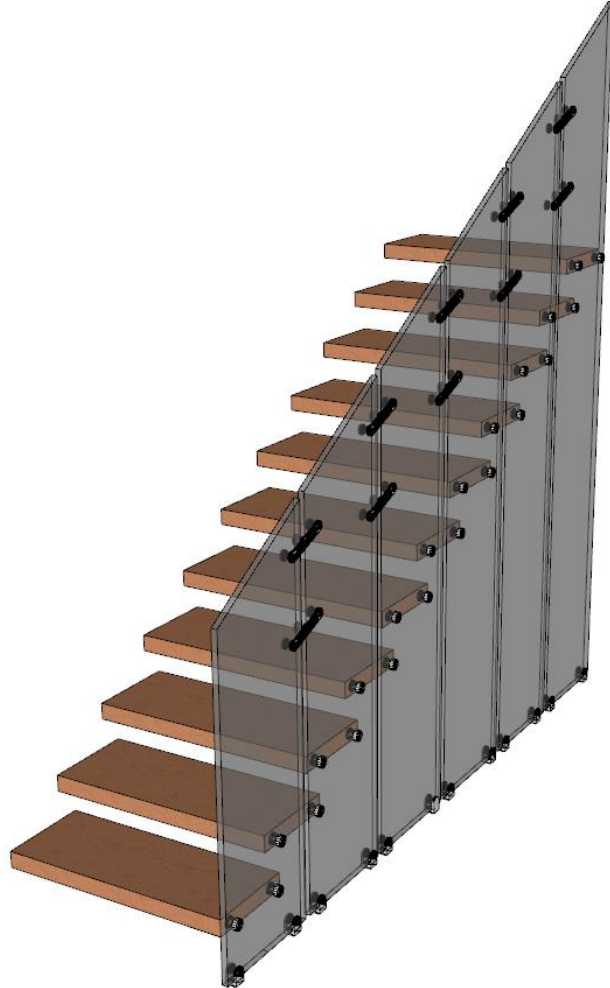

Forma 2

Shape 2
Forme 2
Form 2
Forma 2

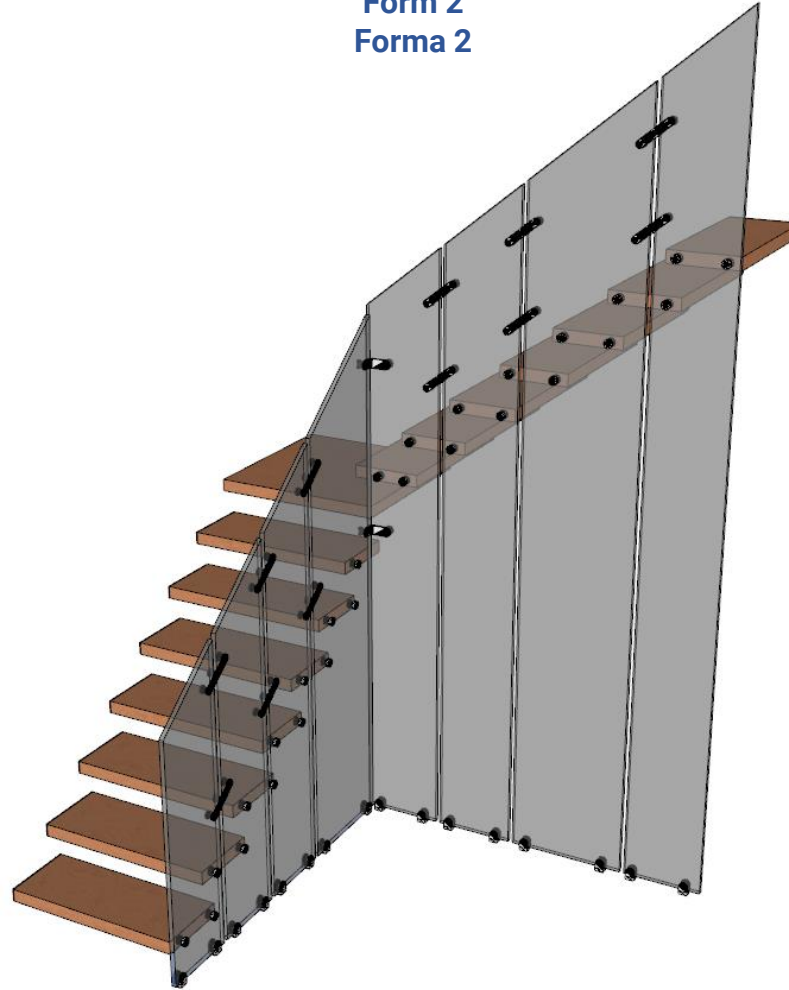

Forma 3

Shape 3
Forme3
Form 3
Forma 3

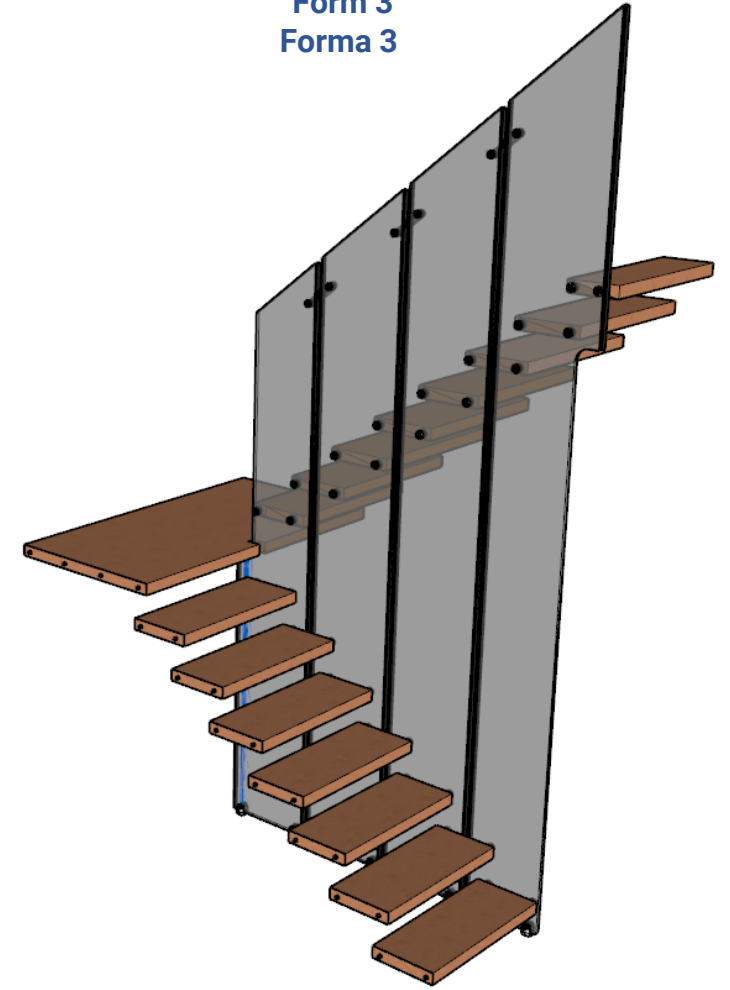

Caratteristiche tecniche

Technical specifications
 Spécifications techniques
 Technische Daten
 Características técnicas

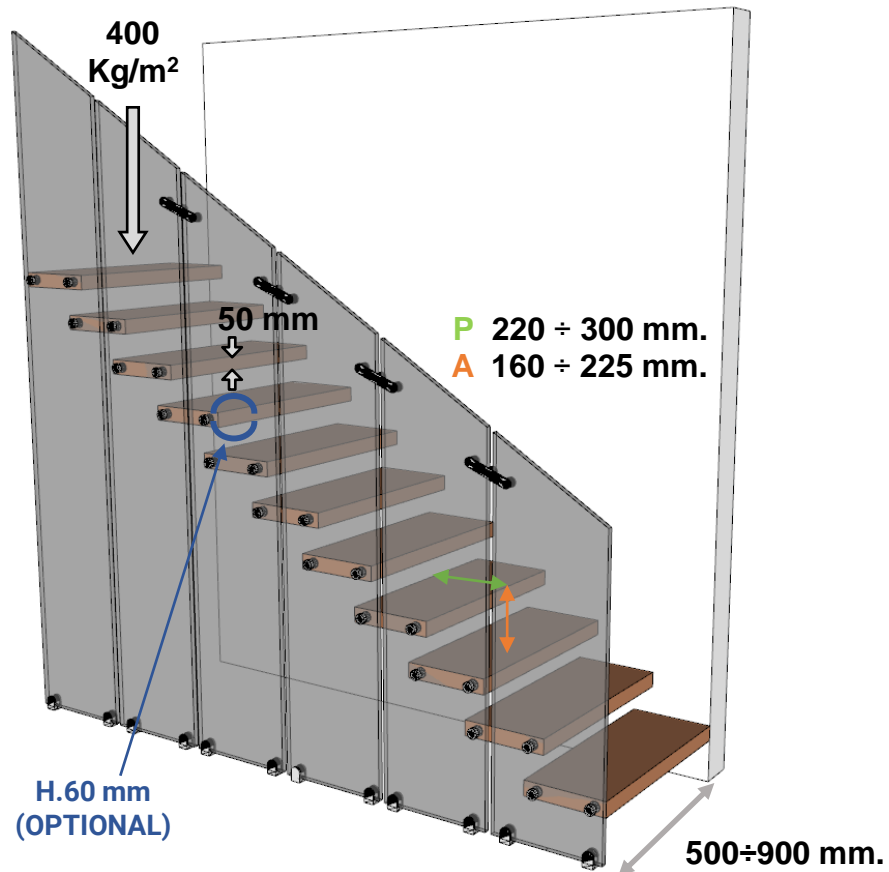

Tipologie di legno disponibili

Type of Wood
 Type de bois
 Holzart
 Tipo de madera



Faggio
 Beech
 Hêtre
 Buche
 Haya



Rovere
 Oak
 Chêne
 Eiche
 Roble

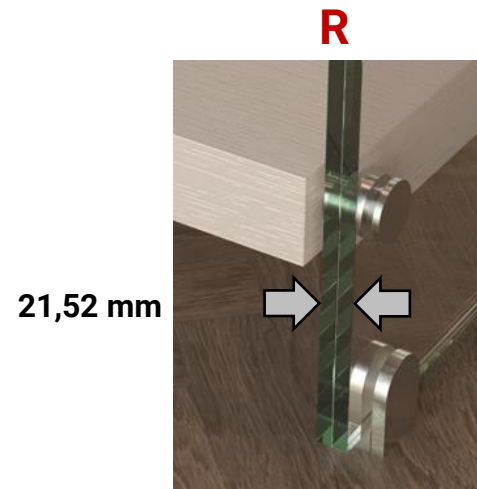

Calcolo passaggio utile

Useful passage - passage utile
 nützliche Passage - Pasaje útil

$$L - R (21,52 \text{ mm}) = P$$

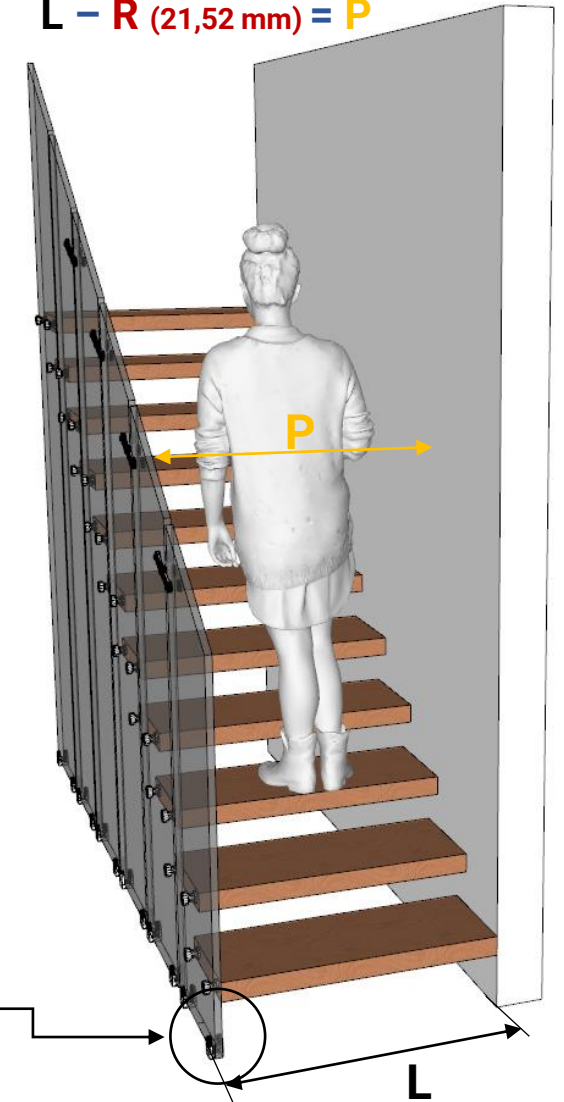

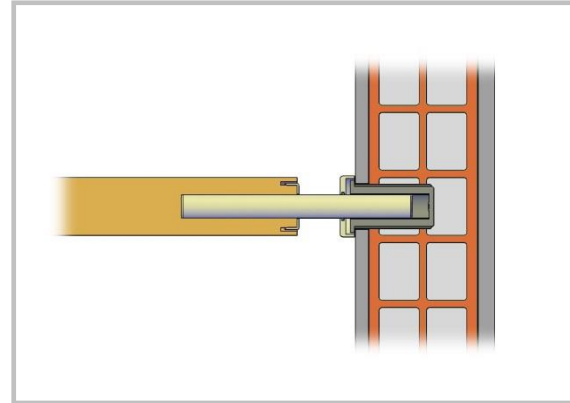
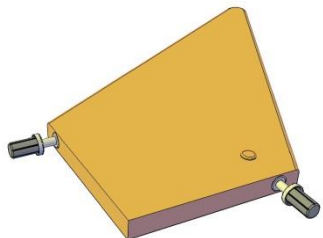
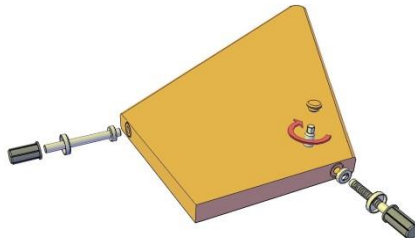
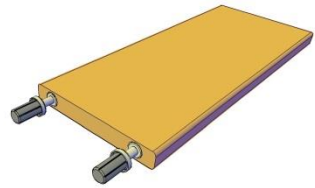
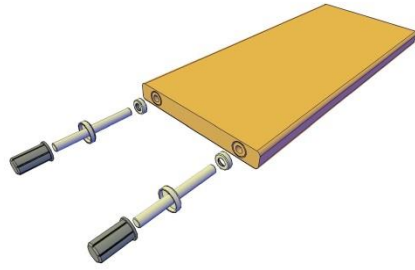

Tramezza
Partition wall
Cloison
Nicht Tragend Wand

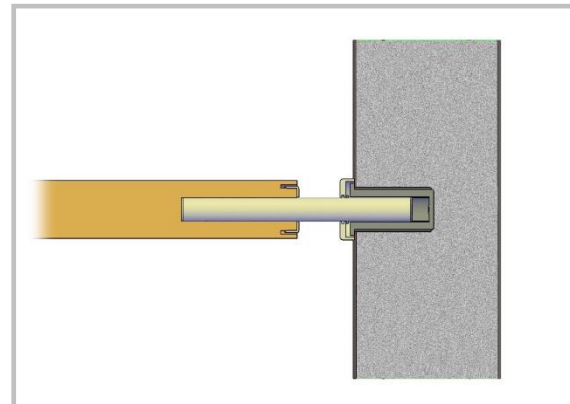

Portante
Bearing Wall
Mur portant
Hauptmauer

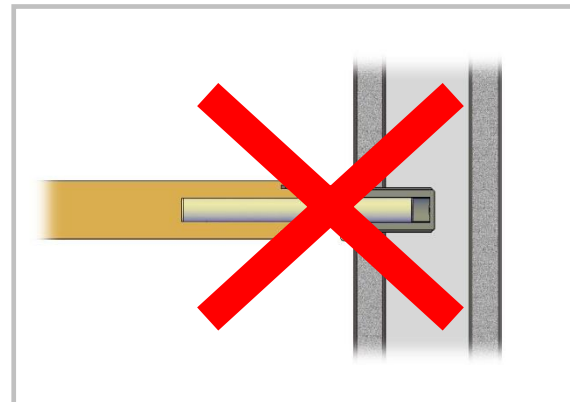

Cartongesso
Plaster board
Placoplâtre
Gipsplatte

ARRIVO CON ALZATA
ARRIVAL WITH RISER
ARRIVÉ AVEC HAUTEUR
ANKUNFT MIT STEIGUNG
LLEGADA CON CONTRAHUELLA

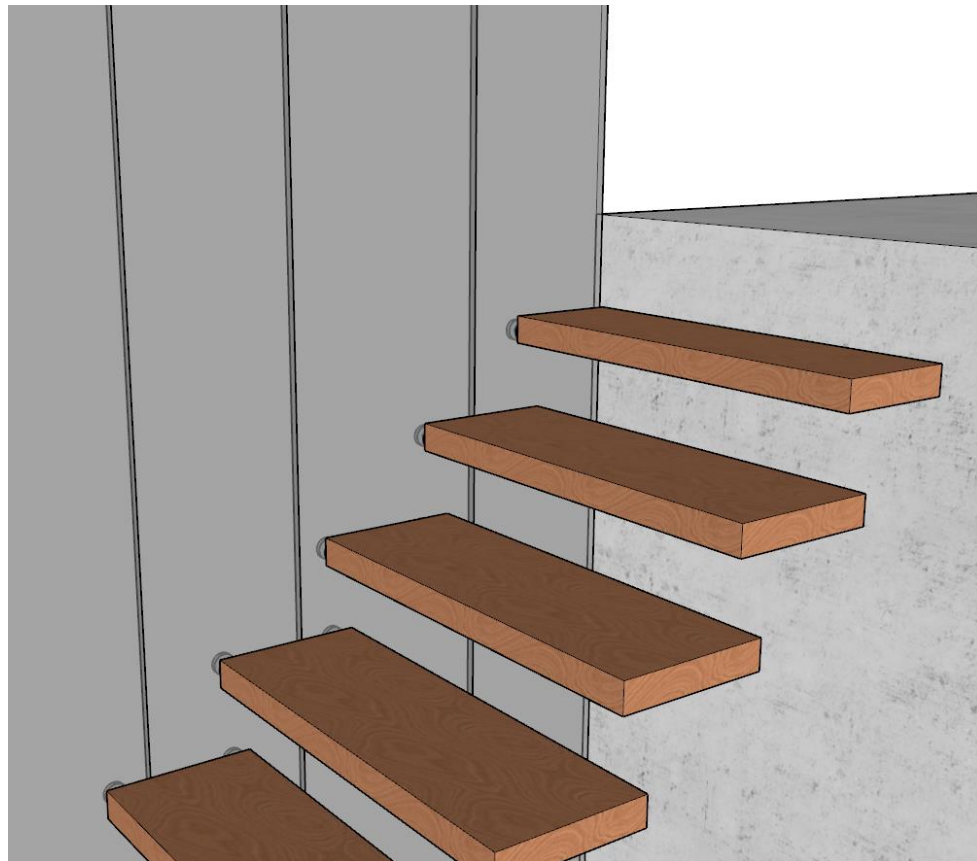

ARRIVO PARI PAVIMENTO
ARRIVAL AT SAME FLOOR LEVEL
ARRIVÉE AU MÊME NIVEAU DU SOL
ERREICHUNG GLEICHEN NIVEAU DES BODENS
LLEGADA MISMO NIVEL QUE EL SUELO

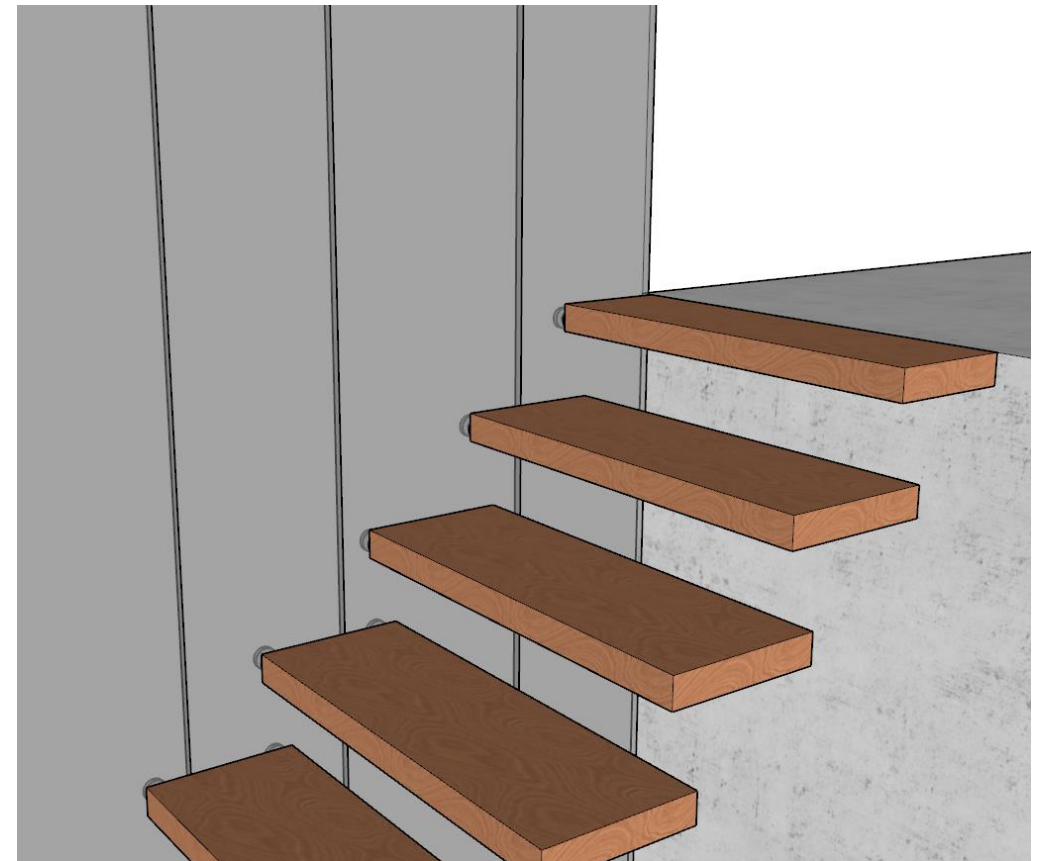

AKURA XR WALL OPTIONAL

Alzate chiuse Closed Risers – Contremarches Setzstufen – Contrahuella cerrada

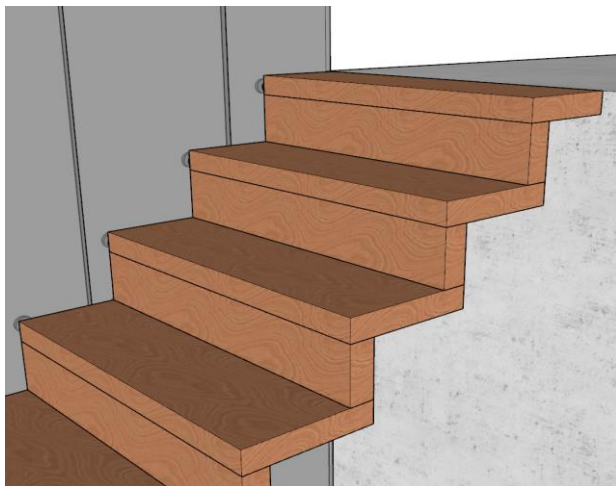

Angolo per pilastro (max 3 gradini) Corner for Pillar (max 3 steps) Angle pour Poteau (max 3 marches) Winkel pro Säule (Max 3 Sufen) Angulo por pilar (máximo 3 escalones)

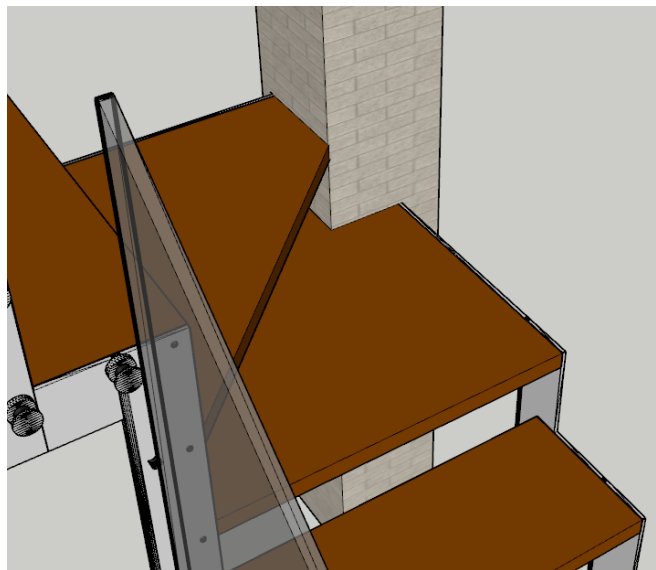

Soglia Threshold – Seuil – Schwellenwert - Umbral

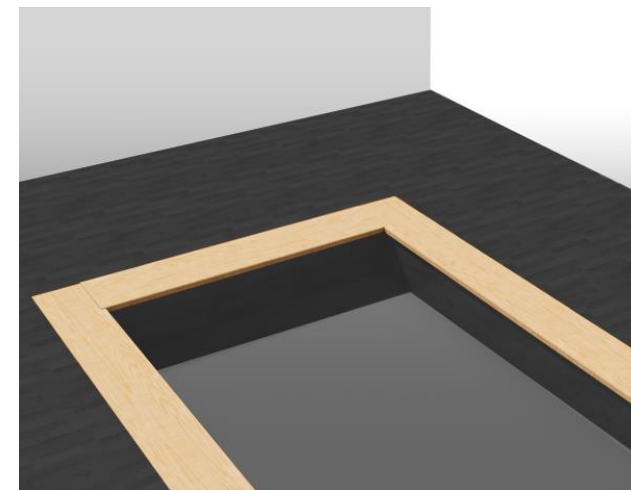

Corrimano a muro- Wall handrail – Main courante murale - Wandhandlauf - Pasamanos de pared



Plug

